

# TECHNICAL DATA SHEET

## 200CENT SQUARE 500LM SWING 90 TRIM IP20

INDOOR - INTERNO - INNENBEREICH - INTERIEUR - INTÉRIEUR - INTERIOR

Adjustable 0° - 90°

⊕ ∅27 mm - h = 70 mm

Material : Aluminium

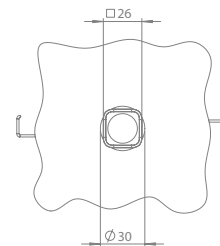

REF N° 200 BL BL  
Black - Black



REF N° 200 WH BL  
White - Black



REF N° 200 BL WH  
Black - White



REF N° 200 WH WH  
White - White

### 200CENT SQUARE SWING 90 500LM CRI 92

2200°K	2700°K	3000°K	4000°K
REF N° 563 28 530	REF N° 563 28 930	REF N° 563 28 830	REF N° 563 28 730

5,9 W - 500lm - 2 Step MacAdam - **A+**  
Serial wiring - - - -   
Requires remote LED driver - 700mA  
Perfect beam 24° - Ultra low glare (UGR < 13)

### REMOTE LED DRIVER ON/OFF

REF N° 697 00 015 min.2W max. 32W

REF N° 697 00 025 min.2W max. 50W

230V/50Hz - - current controlled  
 - - IP20 - 700mA - not dimmable

### REMOTE LED DRIVER DIM

REF N° 697 60 040 min. 3W max. 60W  
1-10V DALI PUSH

REF N° 697 77 010 min. 2W max. 10W PHASE DIM

REF N° 697 77 020 min. 11W max. 20W PHASE DIM

REF N° 697 30 015 min. 2W max. 20W DALI

REF N° 697 60 015 min. 2W max. 20W 1-10V PUSH

230V/50Hz - - current controlled  
 - - IP20 - 700mA - dimmable

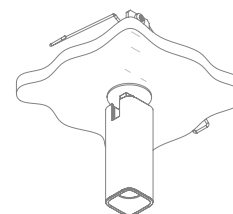
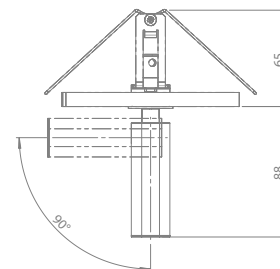

### INSTALLATION KIT

REF N° 680 01 027 standard holesaw ∅27 mm

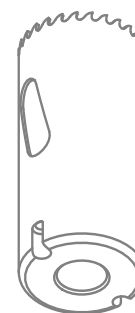

### BEAM ANGLES

STANDARD (included) beam angle 24°

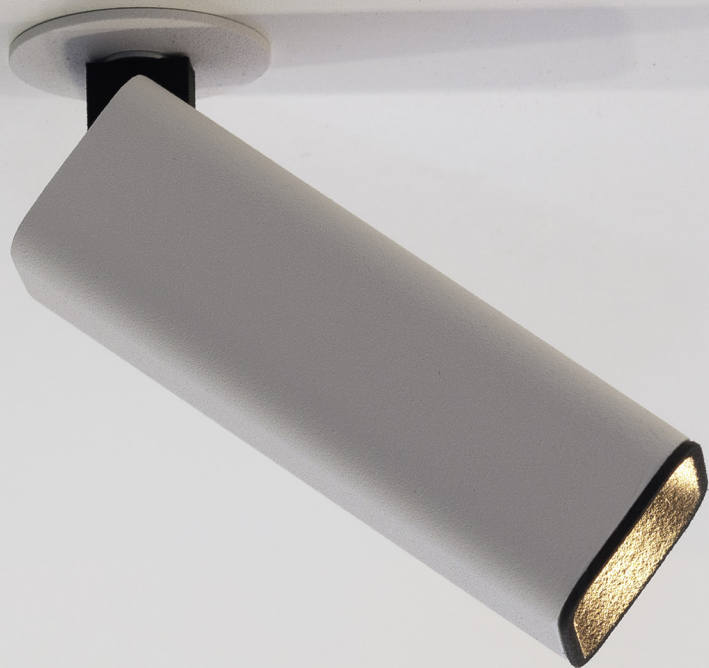

# TECHNICAL DATA SHEET

## 200CENT SQUARE 250LM SWING 90 TRIM IP20

INDOOR - INTERNO - INNENBEREICH - INTERIEUR - INTÉRIEUR - INTERIOR

Adjustable 0° - 90°

Ø27 mm - h = 70 mm

Material : Aluminium

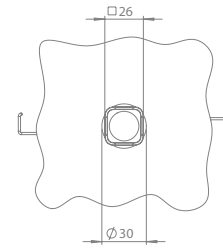

### 200CENT SQUARE SWING 90 250LM CRI 92

2200°K	2700°K	3000°K	4000°K
REF N° 563 27 530	REF N° 563 27 930	REF N° 563 27 830	REF N° 563 27 730

3W - 250lm - 2 Step MacAdam - **A+**  
 Serial wiring - - - -   
 Requires remote LED driver - 1050mA  
 Narrowbeam 12° - Ultra low glare (UGR < 13)

### REMOTE LED DRIVER ON/OFF

REF N° 697 00 015 min.2W max. 39W

REF N° 697 00 025 min.2W max. 50W

230V/50Hz - - current controlled  
 - - IP20 - 1050mA - not dimmable

### REMOTE LED DRIVER DIM

REF N° 697 60 025 min. 2W max. 60W  
 1-10V DALI PUSH

230V/50Hz - - current controlled  
 - - IP20 - 1050mA - dimmable

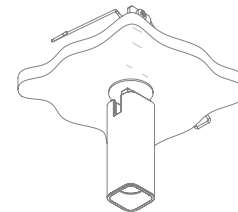
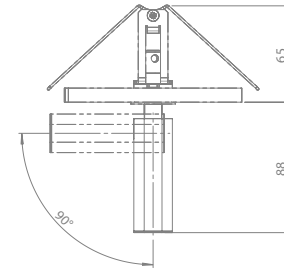

### INSTALLATION KIT

REF N° 680 01 027 standard holesaw Ø27 mm

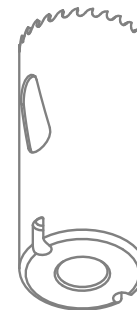

### BEAM ANGLES

STANDARD (included) beam angle 12°



# TECHNICAL DATA SHEET

## 200CENT SQUARE 750LM SWING 90 TRIM IP20

INDOOR - INTERNO - INNENBEREICH - INTERIEUR - INTÉRIEUR - INTERIOR

Adjustable 0° - 90°

Ø27 mm - h = 70 mm

Material : Aluminium

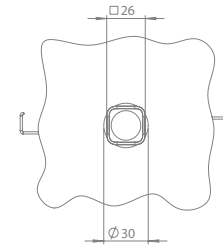

### 200CENT SQUARE SWING 90 750LM CRI 92

2400°K	2700°K	3000°K	4000°K
REF N° 563 29 530	REF N° 563 29 930	REF N° 563 29 830	REF N° 563 29 730

6,2 W - 750lm - 2 Step MacAdam - **A+**  
Serial wiring - - - -   
Requires remote LED driver - 250 mA  
Standard beam angle 36°

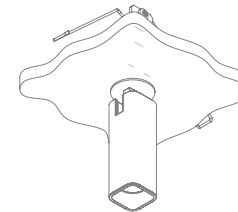
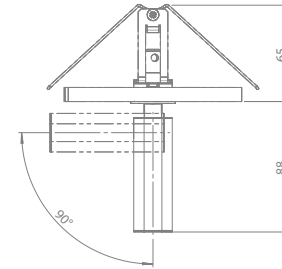

### INSTALLATION KIT

REF N° 680 01 027 standard holesaw Ø27 mm

### REMOTE LED DRIVER ON/OFF

REF N° 697 00 040	min. 1W max. 30W
REF N° 697 00 080	min. 27W max. 67W
230V/50Hz -  - current controlled	
-  - IP20 - 250mA - not dimmable	

### REMOTE LED DRIVER DIM

REF N° 697 60 040	min. 3W max. 30W	1-10V DALI PUSH
REF N° 697 60 150	min. 20W max. 100W	1-10V
REF N° 697 30 150	min. 20W max. 100W	DALI
230V/50Hz -  - current controlled		
-  - IP20 - 250mA - dimmable		

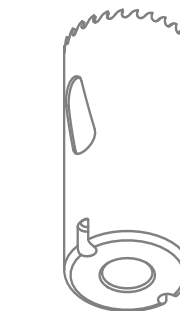

### BEAM ANGLES

STANDARD (included) beam angle 36°



