

TECHNICAL DATA SHEET

200CENT ROUND 250LM W30 FIX TRIMLESS IP20

INDOOR - INTERNO - INNENBEREICH - INTERIEUR - INTÉRIEUR - INTERIOR

Fix (not adjustable) Asymmetric 30°

□ 114x134 mm - h = 105 mm

Material : CALCYT® plaster

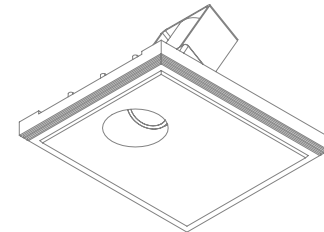
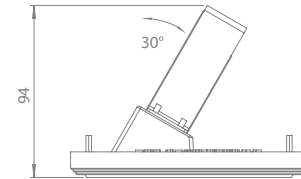
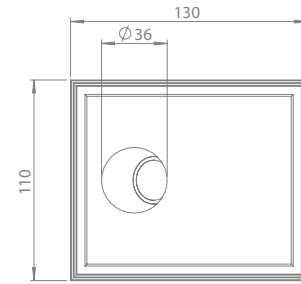

INSTALLATION KIT

- STANDARD** (included) installation system for ceiling 9 - 12 - 15 mm
- REF N° 200 99 025** installation system for gypsum ceiling 25 mm
- REF N° 200 99 030** installation system for gypsum ceiling 30 mm
- REF N° 827 00 000** Concrete box 200CENT - Galvanized steel

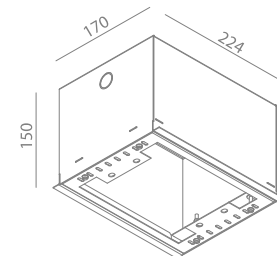

BEAM ANGLES

STANDARD (included) beam angle 12°

REF N° 200 BLACK



Black
Nero
Schwarz
Zwart
Noir
Negro

REF N° 200 WHITE



White
Bianco
Weiß
Wit
Blanc
Blanco

REF N° 200 CHROME



Chrome
Cromo
Chrom
Chroom
Chrome
Cromo

REF N° 200 GOLD

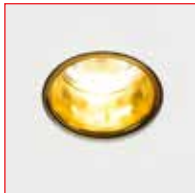

Gold
Oro
Gold
Goud
Or
Oro

REF N° 200 COPPER



Copper
Rame
Kupfer
Koper
Cuivre
Cobre

200CENT ROUND W30 IP20 250LM CRI 92

2200°K	2700°K	3000°K	4000°K
REF N° 511 27 530	REF N° 511 27 930	REF N° 511 27 830	REF N° 511 27 730

3W - 250lm - 2 Step MacAdam - **A+**
Serial wiring - □ - **CE** - ▽ - **IP20**
Requires remote LED driver - 1050mA
Narrow beam 12° - Ultra low glare (UGR < 13)

REMOTE LED DRIVER ON/OFF

REF N° 697 00 015 min.2W max. 39W

REF N° 697 00 025 min.2W max. 50W

230V/50Hz - □ - current controlled
▽ - **CE** - IP20 - 1050mA - not dimmable

REMOTE LED DRIVER DIM

REF N° 697 60 025 min. 2W max. 60W
1-10V DALI PUSH

230V/50Hz - □ - current controlled
▽ - **CE** - IP20 - 1050mA - dimmable



TECHNICAL DATA SHEET

200CENT ROUND 500LM W30 FIX TRIMLESS IP20

INDOOR - INTERNO - INNENBEREICH - INTERIEUR - INTÉRIEUR - INTERIOR

Fix (not adjustable) Asymmetric 30°

□ 114x134 mm - h = 105 mm

Material : CALCYT® plaster

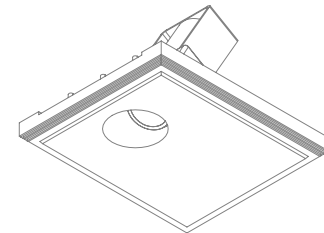
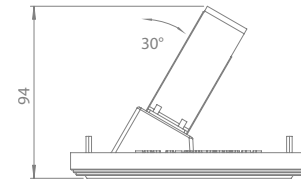
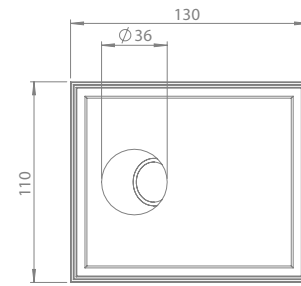

REF N° 200 BLACK

Black
Nero
Schwarz
Zwart
Noir
Negro



REF N° 200 WHITE

White
Bianco
Weiß
Wit
Blanc
Blanco



REF N° 200 CHROME

Chrome
Cromo
Chrom
Chroom
Chrome
Cromo

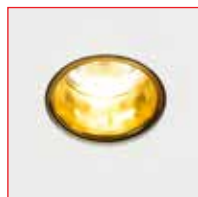

REF N° 200 GOLD

Gold
Oro
Gold
Goud
Or
Oro



REF N° 200 COPPER

Copper
Rame
Kupfer
Koper
Cuivre
Cobre

200CENT ROUND W30 IP20 500LM CRI 92

2200°K	2700°K	3000°K	4000°K
REF N° 511 28 530	REF N° 511 28 930	REF N° 511 28 830	REF N° 511 28 730

5,9 W - 500lm - 2 Step MacAdam - **A+**
Serial wiring - □ - **CE** - ▽ - **IP20**
Requires remote LED driver - 700mA
Perfect beam 24° - Ultra low glare (UGR < 13)

REMOTE LED DRIVER ON/OFF

REF N° 697 00 015 min.2W max. 32W

REF N° 697 00 025 min.2W max. 50W

230V/50Hz - □ - current controlled
▽ - **CE** - IP20 - 700mA - not dimmable

REMOTE LED DRIVER DIM

REF N° 697 60 040 min. 3W max. 60W
1-10V DALI PUSH

REF N° 697 77 010 min. 2W max. 10W PHASE DIM

REF N° 697 77 020 min. 11W max. 20W PHASE DIM

REF N° 697 30 015 min. 2W max. 20W DALI

REF N° 697 60 015 min. 2W max. 20W 1-10V PUSH

230V/50Hz - □ - current controlled
▽ - **CE** - IP20 - 700mA - dimmable

INSTALLATION KIT

- STANDARD** (included) installation system for ceiling 9 - 12 - 15 mm
- REF N° 200 99 025 installation system for gypsum ceiling 25 mm
- REF N° 200 99 030 installation system for gypsum ceiling 30 mm
- REF N° 827 00 000 Concrete box 200CENT - Galvanized steel

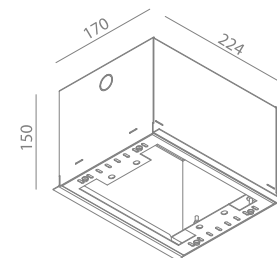

BEAM ANGLES

STANDARD (included) beam angle 24°



TECHNICAL DATA SHEET

200CENT ROUND 750LM W30 FIX TRIMLESS IP20

INDOOR - INTERNO - INNENBEREICH - INTERIEUR - INTÉRIEUR - INTERIOR

Fix (not adjustable) Asymmetric 30°

□ 114x134 mm - h = 105 mm

Material : CALCYT® plaster

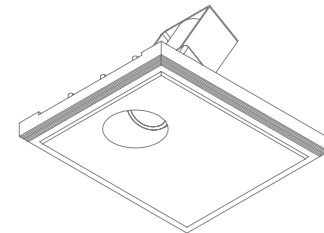
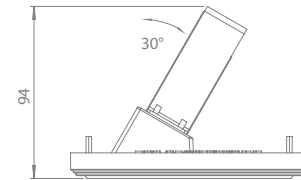
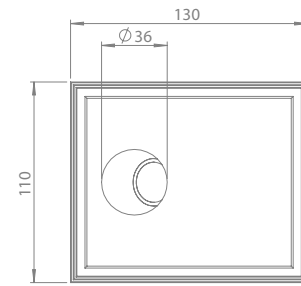

REF N° 200 BLACK

Black
Nero
Schwarz
Zwart
Noir
Negro



REF N° 200 WHITE

White
Bianco
Weiß
Wit
Blanc
Blanco



REF N° 200 CHROME

Chrome
Cromo
Chrom
Chroom
Chrome
Cromo

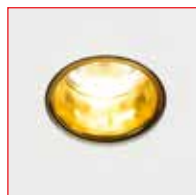

REF N° 200 GOLD

Gold
Oro
Gold
Goud
Or
Oro



REF N° 200 COPPER

Copper
Rame
Kupfer
Koper
Cuivre
Cobre

200CENT ROUND W30 IP20 750LM CRI 92

2400°K	2700°K	3000°K	4000°K
REF N° 511 29 530	REF N° 511 29 930	REF N° 511 29 830	REF N° 511 29 730

6,2 W - 750lm - 2 Step MacAdam - **A+**
Serial wiring - □ - **CE** - ▽ - **IP20**
Requires remote LED driver - 250 mA
Standard beam angle 36°

REMOTE LED DRIVER ON/OFF

REF N° 697 00 040 min.1W max. 30W

REF N° 697 00 080 min. 27W max. 67W

230V/50Hz - □ - current controlled
▽ - **CE** - IP20 - 250mA - not dimmable

REMOTE LED DRIVER DIM

REF N° 697 60 040 min. 3W max. 30W
1-10V DALI PUSH

REF N° 697 60 150 min. 20W max. 100W 1-10V

REF N° 697 30 150 min. 20W max. 100W DALI

230V/50Hz - □ - current controlled
▽ - **CE** - IP20 - 250mA - dimmable

INSTALLATION KIT

STANDARD (included) installation system for ceiling 9 - 12 - 15 mm
REF N° 200 99 025 installation system for gypsum ceiling 25 mm
REF N° 200 99 030 installation system for gypsum ceiling 30 mm
REF N° 827 00 000 Concrete box 200CENT - Galvanized steel

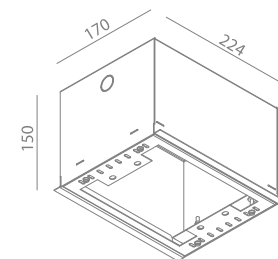

BEAM ANGLES

STANDARD (included) beam angle 36°

